

PANEL COMPONENTS

LED INDICATOR LAMPS 24V AND 230V OPTIONS



One piece LED indicator units for front of panel mounting. Standard 22.5mm hole fixing. Terminal covers are colour coded for easy identification. Long life multiple LED clusters. Supplied complete with locknut

General Characteristics

Rated Voltage Options	24VAC/DC or 230 VAC
Current consumption	16 - 72 mA
LED life	> 30 000 hours
LED brightness	> 60cd/m ²
Terminal Capacity	up to 1.5mm ²
Screw thread	M3
Tightening Torque	0.5 Nm
Diameter of lens	29mm
Depth of lens	13mm
Back of panel depth	33mm
Maximum thickness for fixing	6mm
Weight	0.075Kg

Available Colours

R	Red
Y	Yellow
G	Pure green
B	Pure blue
W	Pure white

Technical Drawing

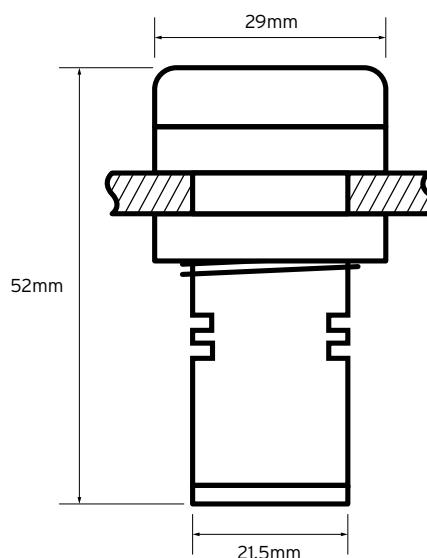

Additional Information

This product is for use by skilled persons or instructed persons. The installation of this product must comply with current IEE regulations. Terminals, including those factory fitted, must be checked for correct tightness before commissioning. All terminals should be periodically checked for correct tightness. The data herein serves only to describe the product and should not be regarded as representing guaranteed properties in the legal sense. We reserve the rights of modification, whilst every care has been taken in ensuring the accuracy of this catalogue, the Supplier accepts no liability whatsoever for any eventuality arising from errors or omissions within its catalogues, brochures or within any online presence.