

### PLASTIC EMPTY PUSH-BUTTON STATIONS



**Empty enclosure for building a control station. Single hole. ABS plastic construction**

#### General Characteristics

Standard	EN 60947-5-1
Ingress protection	IP65
Number of gangs	1 / 2 / 3
Hole size	22.5mm
Knockouts	1 x 20mm top and bottom

#### Available Sizes

PPS1	74 x 68 x 38mm (HxWxD)
PPS2	104 x 68 x 38mm (HxWxD)
PPS3	134 x 68 x 38mm (HxWxD)

#### Available accessories

PSA-B	Black push-button head
PSA-BW	Black with white arrow push-button head
PSA-BL	Blue push-button head
PSA-GW	Green with white I push-button head
PSA-RW	Red with white O push-button head
PSA-W	White push-button head
PSA-WB	White with black arrow push-button head
PSA-Y	Yellow push-button head
PSA-2SS	2 position selector switch
PA-CB1NC	Contact block only 1NO
PA-CB1NO	Contact block only 1NC

#### Technical Drawing

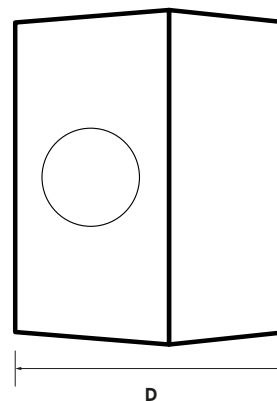
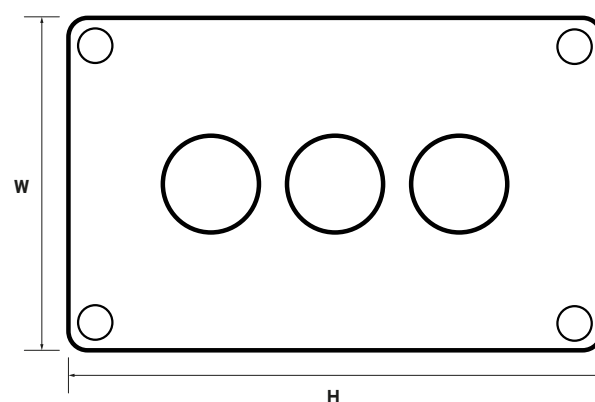

#### Additional Information

This product is for use by skilled persons or instructed persons. The installation of this product must comply with current IEE regulations. Terminals, including those factory fitted, must be checked for correct tightness before commissioning. All terminals should be periodically checked for correct tightness. The data herein serves only to describe the product and should not be regarded as representing guaranteed properties in the legal sense. We reserve the rights of modification, whilst every care has been taken in ensuring the accuracy of this catalogue, the Supplier accepts no liability whatsoever for any eventuality arising from errors or omissions within its catalogues, brochures or within any online presence.