

## PANEL COMPONENTS

### INSULATED DISTRIBUTION BOX - TDISTRO1



Robust, portable, stackable distribution box made of black polyamide with steel carry handle.

#### General Characteristics

<b>Standards</b>	BS EN 60309-1 & 2
<b>Voltage</b>	415V
<b>Maximum rated current</b>	16A
<b>Degree of Ingress</b>	IP44
<b>Input plug</b>	415V 5pin 16A
<b>Input cable</b>	H07RN-F 5G2.5
<b>Cable length</b>	2m
<b>RCD protection</b>	40A 30mA
<b>16A socket</b>	2 x 5pin 415V
<b>16A socket</b>	1 x 3pin 240V
<b>13A socket</b>	4 x 3pin 240V
<b>Dimensions</b>	197 x 197 x 200mm

#### Technical Drawing

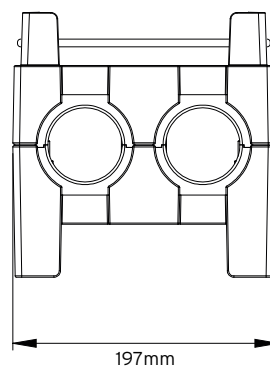
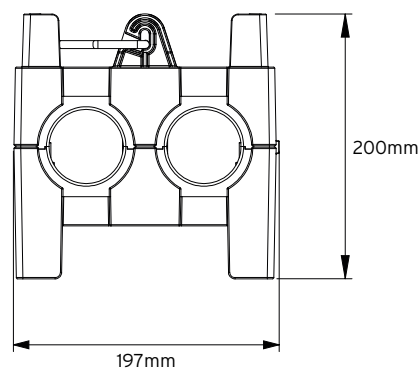

#### Additional Information

This product is for use by skilled persons or instructed persons. The installation of this product must comply with current IEE regulations. Terminals, including those factory fitted, must be checked for correct tightness before commissioning. All terminals should be periodically checked for correct tightness. The data herein serves only to describe the product and should not be regarded as representing guaranteed properties in the legal sense. We reserve the rights of modification, whilst every care has been taken in ensuring the accuracy of this catalogue, the Supplier accepts no liability whatsoever for any eventuality arising from errors or omissions within its catalogues, brochures or within any online presence.