

PANEL COMPONENTS

INSULATED DISTRIBUTION BOX - TDISTRO3



Robust, portable, stackable distribution box made of black polyamide with steel carry handle.

General Characteristics

Standards	BS EN 60309-1 & 2
Voltage	415V
Maximum rated current	32A
Degree of Ingress	IP44
Input plug	415V 5pin 16A
Input cable	H07RN-F 5G2.5
Cable length	2m
RCD protection	63A 30mA
32A socket	1 x 5pin 415V
16A socket	2 x 3pin 415V
16A socket	4 x 3pin 240V
13A socket	3 x 3pin 240V
Dimensions	200 x 300 x 200mm

Technical Drawing

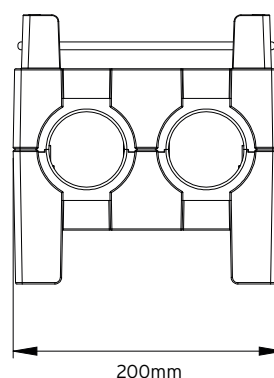
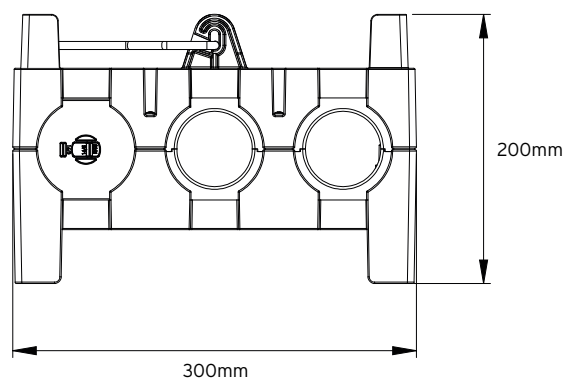

Additional Information

This product is for use by skilled persons or instructed persons. The installation of this product must comply with current IEE regulations. Terminals, including those factory fitted, must be checked for correct tightness before commissioning. All terminals should be periodically checked for correct tightness. The data herein serves only to describe the product and should not be regarded as representing guaranteed properties in the legal sense. We reserve the rights of modification, whilst every care has been taken in ensuring the accuracy of this catalogue, the Supplier accepts no liability whatsoever for any eventuality arising from errors or omissions within its catalogues, brochures or within any online presence.