

## Installation Essentials

# Safeplate®

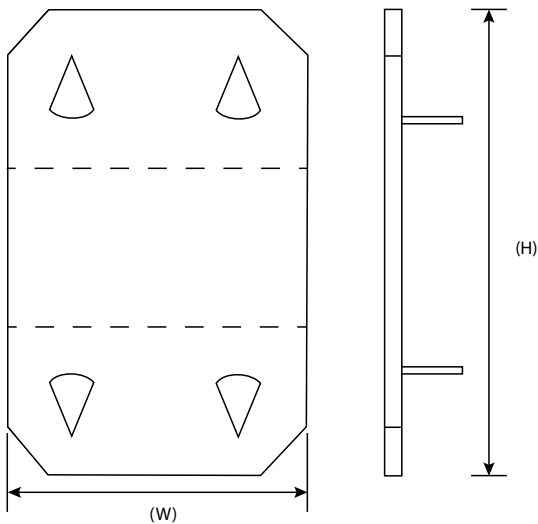

### Technical Drawing



### Technical Specifications

<b>Standard of Compliance</b>	18th edition IEE Wiring Regs.
<b>Material</b>	Structural Galv. Carbon Steel
<b>Tensile yield</b>	350 min

### Dimensions

<b>List No.</b>	SP1	SP2	SP3
<b>Dimensions</b>	52 x 75mm	50 x 152mm	50 x 100mm