

# niGLON

## Circuit Protection

# Arc Fault Detection Device(RCBO) B Curve Single Pole



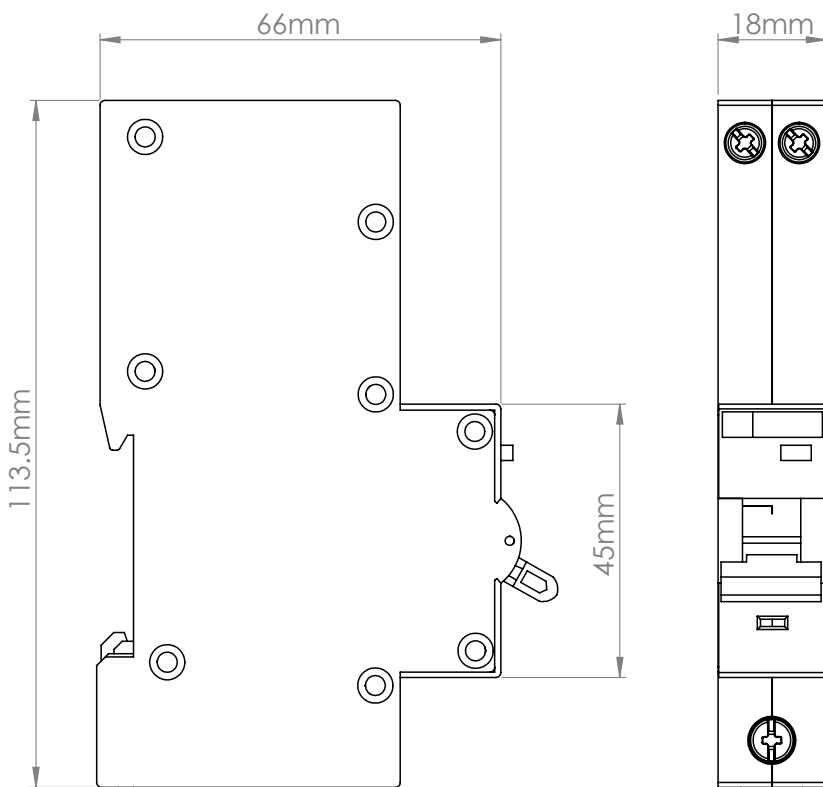

### Technical Drawing



### The Range

List No	Rating
AFDD6B1-6A	6A 30mA "B"
AFDD6B1-10A	10A 30mA "B"
AFDD6B1-16A	16A 30mA "B"
AFDD6B1-20A	20A 30mA "B"
AFDD6B1-32A	32A 30mA "B"
AFDD6B1-40A	40A 30mA "B"

### Technical Specifications

Max Rating	230V
RCD Type	A
Tripping Curve	Type A
Breaking Capacity	6kA
Rated tripping current	30mA
Cable Capacity	25mm <sup>2</sup> line in 10mm <sup>2</sup> live out/neutral out
Standards	BS EN 61009-1, BS EN 62606 intertek  
Dimensions (HxWxD)	18 x 113.5 x 66mm
Serial Arc Fault Protection	Yes
Parallel Arc Fault Detection	Yes
Single Module	Yes