

# niglon

## Earthing

### BCBR

#### Standard 'B' Type rod to cable lug clamp for CBER4

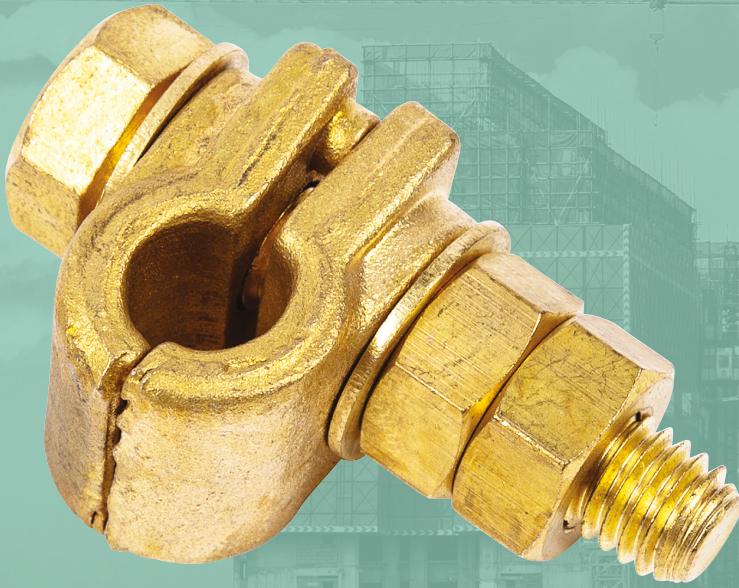

#### Technical Drawing

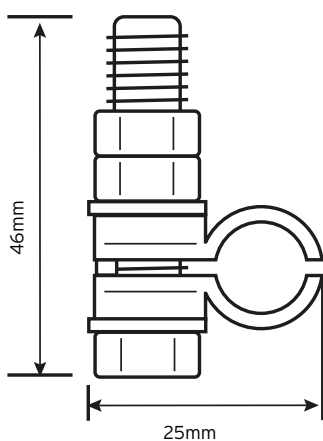

#### Technical Specifications

Connector Type	Screw
Weight	0.260Kg
Material	Brass
Standards of Compliance	BS 7430
Dimensions	46 x 20 x 25mm (H x W x D)