

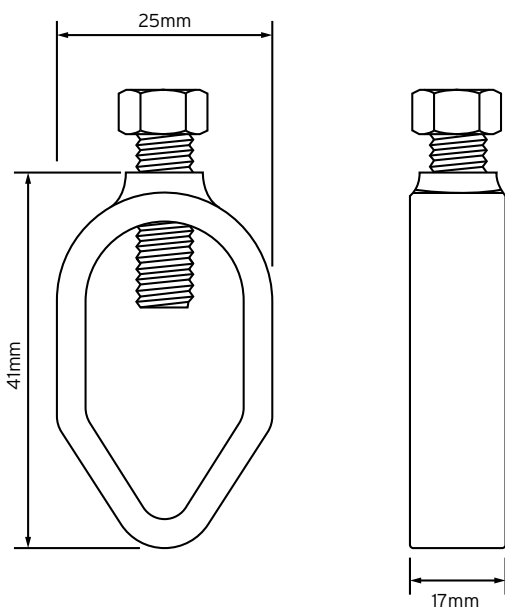

SDCC58

Standard 'G' Type cable clamp for 5/8" Rod

Technical Drawing



Technical Specifications

Conductor Range	6-70mm ² /70-120mm ²
Weight	0.10kg
Material	Gunmetal (Body) Phosphor Bronze (M10 x 25mm Set Screw)
Suitable for use with	8mm Ø solid circular copper conductor
Dimensions	41 x 25 x 17mm/48 x 30 x 19mm (H x W x D)
Standards	BS EN 62561