

PANEL COMPONENTS

METAL EMPTY PUSH-BUTTON STATIONS MPS1 , MPS2 , MPS3



**22mm hole, empty control station for surface mount.
Die cast aluminium construction**

General Characteristics

Standard	BSEN 60947-5-1
Knockouts	1 x 20mm top and bottom
Ingress protection	IP65
Construction	Aluminium
Number of gangs	1, 2 or 3

Available Sizes (HxWxD)

MPS1	105x68x51mm
MPS2	117x68x51mm
MPS3	134x68x51mm

Available accessories

PL2##-#	LED Indicator
FPBH-	Flush Pushbutton
PPBH-	Projecting Pushbutton
RPBH-COLOUR	Booted Pushbutton
MPBH-R#	Mushroom Head Pushbutton
SHS###	Selector Switch
SHK###	Key Selector Switch
JS###	Joystick
CBC1NO	Contact assembly 1NO
CBC1NC	Contact assembly 1NC

Technical Drawing

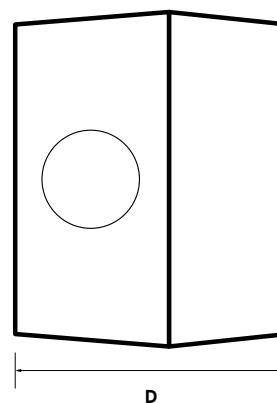
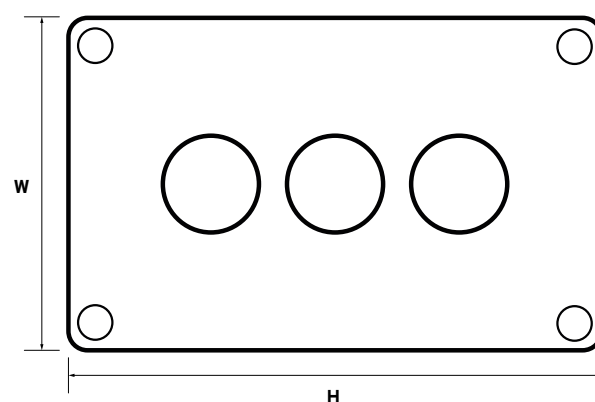

Additional Information

This product is for use by skilled persons or instructed persons. The installation of this product must comply with current IEE regulations. Terminals, including those factory fitted, must be checked for correct tightness before commissioning. All terminals should be periodically checked for correct tightness. The data herein serves only to describe the product and should not be regarded as representing guaranteed properties in the legal sense. We reserve the rights of modification, whilst every care has been taken in ensuring the accuracy of this catalogue, the Supplier accepts no liability whatsoever for any eventuality arising from errors or omissions within its catalogues, brochures or within any online presence.